

Current part is item (1) on diagram. Available at [www.oshkosequipment.com](http://www.oshkosequipment.com)

(1) (a) FIG. NO.	(2) (b) ITEM NO.	(3) SMR CODE	(4) NATIONAL STOCK NUMBER	(5) PART NUMBER	(6) FSCM	(7) DESCRIPTION USABLE ON CODE	(8) U/M INC IN UNIT
						0613-HULL OR CHASSIS WIRING HARNESS (CONT'D)	
91	5	PAOZZ	5340-00-993-6207	MS21333-99	96906	CLAMP, LOOP	EA 4
91	6	PAOZZ	2590-00-394-9720	11609718	19207	HARNES: REAR SIDE CLEARANCE LIGHTS (M756A2)	EA 1
91	7	PAOZZ	5935-00-900-6281	MS27147-1	96906	ADAPTER, CONNECTOR: REAR SIDE CLEARANCE LIGHTS (M756A2)	EA 2
91	8	PAOZZ	5325-00-276-6056	MS35489-106	96906	GROMMET, RUBBER: FLOODLIGHT, REAR SIDE AND REAR END HARNES (M756A2)	EA 7
91	9	PAOZZ	2590-00-399-5297	11609719	19207	HARNES: REAR CLEARANCE LIGHTS (M56A2)	EA 1
91	10	PAOZZ	5310-00-934-9758	MS35649-202	96906	NUT, PLAIN, HEXAGON: BODY CLEARANCE LIGHTS (M756A2)	EA 72
91	11	PAOZZ	5310-00-596-7691	MS35335-32	96906	WASHER, LOCK: BODY CLEARANCE (M756A2)	EA 72
91	NI	PAOZZ	2590-00-832-9976	8722943	19207	CLIP, CONNECTOR: WIRING HARNESS TO BODY CLEARANCE LIGHTS (M756A2)	EA 4
91	NI	PAOZZ	5305-00-068-0506	MS90726-6	96906	SCREW, CAP, HEXAGON HEAD: CLIP AND CLAMPS AT BODY SIDE CLEARANCE LIGHTS AND HARNESS (M756A2)	EA 8
91	NI	PAOZZ	5310-00-959-7600	MS51922-5	96906	NUT, SELF-LOCKING: CLIP AND CLAMPS AT BODY SIDE CLEARANCE LIGHTS AND HARNES (M756A1)	EA 8
91	NI	PAOZZ	5340-00-523-5996	7373268	19207	CLAMP, LOOP: HARNESS TO BODY SIDE CLEARANCE LIGHTS (M756A2)	EA 2
91	NI	PAOZZ	2590-00-388-9977	11609717	19207	HARNES: FRONT BODY SIDE CLEARANCE LIGHTS (M756A2)	EA 1
91	NI	PAOZZ	5310-00-947-6980	MS45904-71	96906	WASHER, LOCK: CLAMP FOR FLOODLIGHT HARNES (M756A2)	EA 1
91	NI	PAOZZ	5330-00-514-4462	7716716	19207	RETAINER, PACKING (M756A2)	EA 2
91	NI	PAOZZ	5340-00-964-5267	MS21333-120	96906	CLAMP, LOOP: HARNESS TO REAR CLEARANCE LIGHTS (M756A2)	EA 2
91	NI	PAOZZ	2590-00-388-9980	11609716	19207	HARNES ASSEMBLY: FLOOD AND CLEARANCE LIGHTS	EA 1
91	NI	PAOZZ	6220-00-577-3434	MS35423-1	96906	LIGHT, MARKER: FRONT, CLEARANCE, SERVICE	EA 5
91	NI	PAOZZ	6220-00-577-3435	MS35424-1	96906	LIGHT, MARKER: SIDE, CLEARANCE, BLACKOUT	EA 2
91	NI	PAOZZ	5325-00-432-7380	11640443	19207	GROMMET	EA 2
92	1	PAOZZ	5310-00-959-7600	MS51922-5	96906	NUT, SELF-LOCKING	EA 4
92	2	PAOZZ	5310-00-889-2528	MS45904-68	96906	WASHER, LOCK	EA 4
92	3	PAOZZ	5305-00-068-0507	MS90726-7	96906	SCREW, CAP, HEXAGON HEAD	EA 4

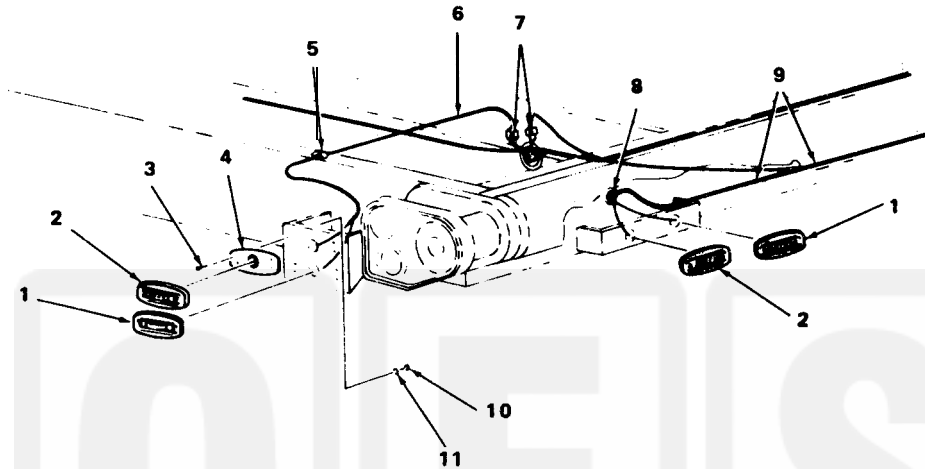



TA 031160

Figure 91. Rear wiring harness (M756A2).

Oshkosh  
Equipment Sales

Current part is item (1) on diagram. Available at [www.oshkoshequipment.com](http://www.oshkoshequipment.com)

(1) (a) FIG. NO.	(2) (b) ITEM NO.	(3) SMR CODE	(3) NATIONAL STOCK NUMBER	(4) PART NUMBER	(5) FSCM	(6) DESCRIPTION USABLE ON CODE	(7) U/M	(8) INC IN UNIT
1812-SPECIAL PURPOSE BODIES								
200	1	PAOZZ	6220-00-577-3434	MS35423-1	96906	LIGHT, MARKER, CLEARANCE: AMBER SERVICE (M292, M292A1, M292A2, M292A5)	EA	2
200	2	PAOZZ	6220-00-577-3435	MS35424-1	96906	LIGHT, MARKER, CLEARANCE: AMBER BLACKOUT 24V (M292, M292A1, M292A2, M292A5)	EA	2
200	3	PAOZZ	5999-00-057-2929	MS27148-2	96906	PIN (M292, M292A1, M292A2, M292A5)	EA	2
200	4	PAOZZ	6220-00-729-9295	MS35422-1	96906	BAND, MARKER (M292, M292A1, M292A2, M292A5)	EA	2
200	5	PAOZZ	5306-00-225-8500	MS90725-35	96906	BOLT (M292, M292A1, M292A2, M292A5)	EA	16
200	6	PAOZZ	5975-00-403-9490	8342290	19207	PLATE, WALL ELECTRICAL (M292, M292A1, M292A2, M292A5)	EA	8
200	7	PAOZZ	5930-00-259-8154	7002826	19207	SWITCH, TOGGLE: 3 WAY, CEILING (M292A1, M292A2, M292A5)	EA	8
200	8	XBOZZ		8365294	19207	CONNECTOR, RECEPTACLE: CEILING PLUG (M292, M292A1, M292A2, M292A5)	EA	8
200	9	PAOOO	6220-00-338-1086	7092284	19207	LIGHT, DOME: 110V, BLUE (M292, M292A1, M292A2, M292A5)	EA	1
200	10	PAOZZ	5305-00-855-0836	MS24615-38	96906	SCREW (M292, M292A1, M292A2, M292A5)	EA	4
200	11	PAOZZ	6220-00-025-3697	8328123	19207	LENS, DOME LIGHT: BLUE (M292, M292A1, M292A2, M292A5)	EA	1
200	12	PAOZZ	5330-00-205-0089	8328224	19207	FELT: DOME LIGHT LENS (M292, M292A1, M292A2, M292A5)	EA	1
200	13	PAOZZ	6240-00-577-3425	25AB115-125V	08805	LAMP, INCANDESCENT: ELECTRIC, 115V-125V, 25W, BLUE CEILING LIGHT, BLACKOUT (M292, M292A1, M292A2, M292A5)	EA	1
200	14	XBOZZ	5305-00-855-0836	MS24615-38	96906	SCREW (M292, M292A1, M292A2, M292A5)	EA	4
200	15	XBOZZ		7759185	19207	COVER (M292, M292A1, M292A2, M292A5)	EA	1
200	23	XBOZZ		7535635-1	19207	BOX ASSEMBLY (M292, M292A1, M292A2, M292A5)	EA	1
200	24	XBOZZ		7535637	19207	BOX ASSEMBLY (M292, M292A1, M292A2, M292A5)	EA	1
200	25	PAOZZ	2590-00-234-3248	7535639	19207	HARNESS: TELEPHONE POST (M292, M292A1, M292A2, M292A5)	EA	1
200	26	XBOZZ		7535568	19207	HARNESS (M292, M292A1, M292A2, M292A5)	EA	1
200	27	XBOZZ		7535571	19207	HARNESS (M292, M292A1, M292A2, M292A5)	EA	1
200	28	XBOZZ		7535569	19207	HARNESS (M292, M292A1, M292A2, M292A5)	EA	1
200	29	PAOZZ	2590-00-689-3385	10871777	19207	HARNESS ASSEMBLY: HEATERS TO FUEL PUMP (M292, M292A1, M292A2, M292A5)	EA	1



Current part is item (1) on diagram. Available at [www.oshkoshequipment.com](http://www.oshkoshequipment.com)

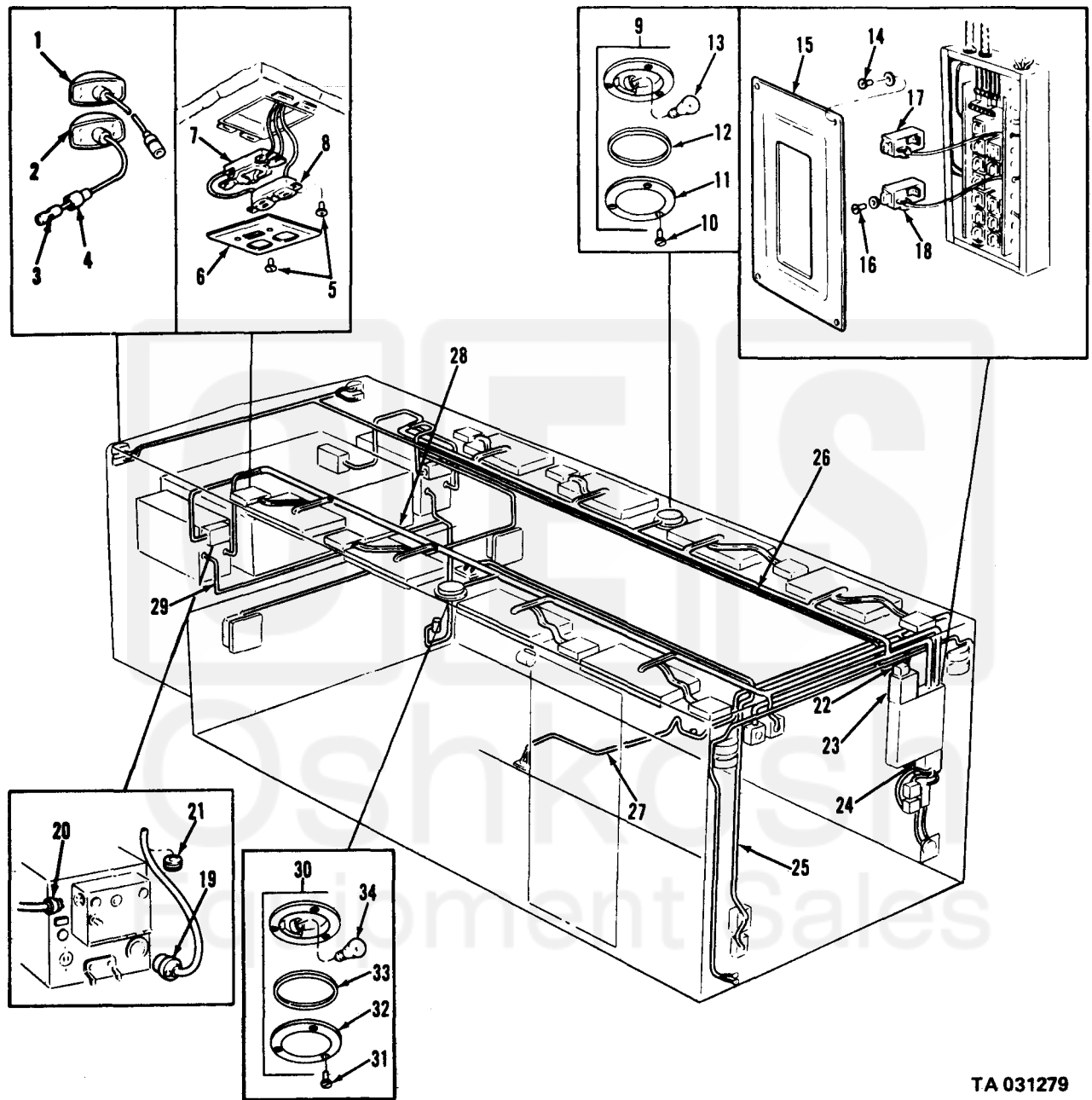

TA 031279

Figure 200. Expansible van electrical system.